

# OFFICE BUILDING SALE OR LEASE

**ROSE**  
COMMERCIAL REAL ESTATE

**22 SOUTH MAPLE AVENUE  
MARLTON, NJ**

**EXCLUSIVE LISTING**



For Further Information, Please Contact:

**Danny Wolf (Ext. 23)**

**(856) 985-9522**

**dwolf@rosecommercial.com**

**Property Description:** Office Building for Sale or Lease

**Size:**  
1,342 +/- SF Second Floor  
1,342 +/- SF First Floor  

---

2,684 +/- SF Total

**Block/Lot:** 4.01/20.01

**Zoning:** C-3 Commercial

**Sale Price:** \$450,000.00

**Lease Rate:** \$18.00/SF Plus Utilities

**Taxes:** \$8,365 (2012)

**Comments:**

- Wired for Internet Access, Telephone, and Fax
- Overhead Florecent Lighting and Central Air
- Public Water & Sewer
- Natural Gas
- Abundant Parking
- Excellent Signage
- Newer Roof & Windows
- Easy Access to Routes 73 & 70
- Great Proximity to Local Shopping, Restaurants & Banks

**First Floor:**

- Waiting Room, Reception Area, Two (2) Offices and One (1) Bathroom

**Second Floor:**

- Four (4) Offices, One (1) Copy

## 2011 DEMOGRAPHICS

Category	1 Mile	3 Miles	5 Miles
Population	9,732	69,923	157,215
Avg HH Income	\$96,027	\$126,641	\$123,710
Daytime Poplulation	29,423	97,022	202,029

ALL INFORMATION FURNISHED REGARDING PROPERTY FOR SALE, RENTAL OR FINANCING IS FROM SOURCES DEEMED RELIABLE, BUT NO WARRANTY OR REPRESENTATION IS MADE AS TO THE ACCURACY THEREOF AND SAME IS SUBMITTED SUBJECT TO ERRORS, OMISSIONS, CHANGE OF PRICE, RENTAL OR OTHER CONDITIONS, PRIOR SALE, LEASE OR FINANCING OR WITHDRAWAL WITHOUT NOTICE. NO LIABILITY OF ANY KIND IS TO BE IMPOSED ON THE BROKER HEREIN.

12000 Lincoln Drive West, Suite 111 • Marlton, NJ 08053 • Phone: (856) 985-9522 • Fax: (856) 985-9488

www.rosecommercial.com

# BUILDING LAYOUTS



22 SOUTH MAPLE AVENUE  
MARLTON, NJ

EXCLUSIVE LISTING

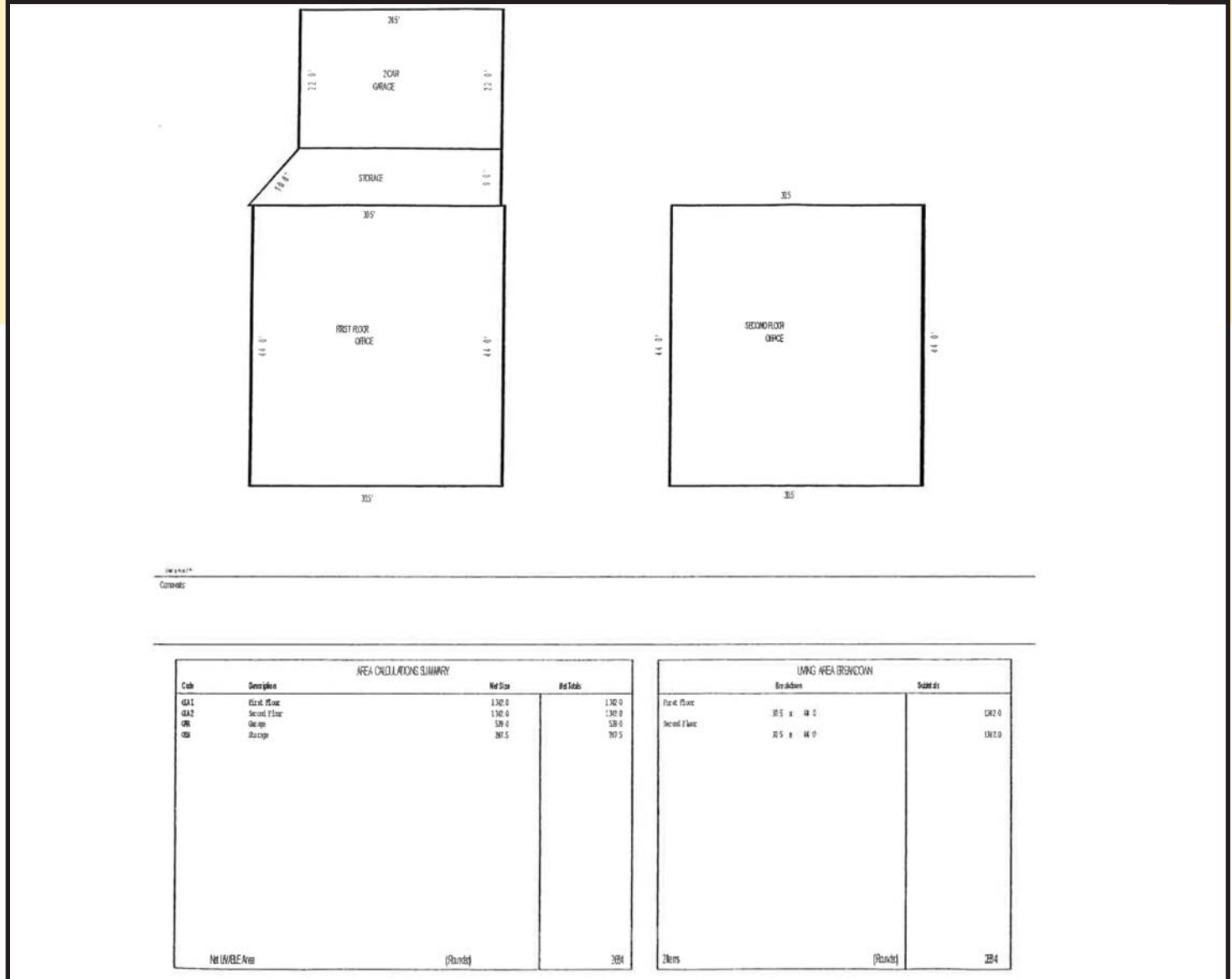

ALL INFORMATION FURNISHED REGARDING PROPERTY FOR SALE, RENTAL OR FINANCING IS FROM SOURCES DEEMED RELIABLE, BUT NO WARRANTY OR REPRESENTATION IS MADE AS TO THE ACCURACY THEREOF AND SAME IS SUBMITTED SUBJECT TO ERRORS, OMISSIONS, CHANGE OF PRICE, RENTAL OR OTHER CONDITIONS, PRIOR SALE, LEASE OR FINANCING OR WITHDRAWAL WITHOUT NOTICE. NO LIABILITY OF ANY KIND IS TO BE IMPOSED ON THE BROKER HEREIN.

For Further Information, Please Contact:

**Danny Wolf (Ext. 23)**

**(856) 985-9522**

**[dwolf@rosecommercial.com](mailto:dwolf@rosecommercial.com)**